

CRYSTAL

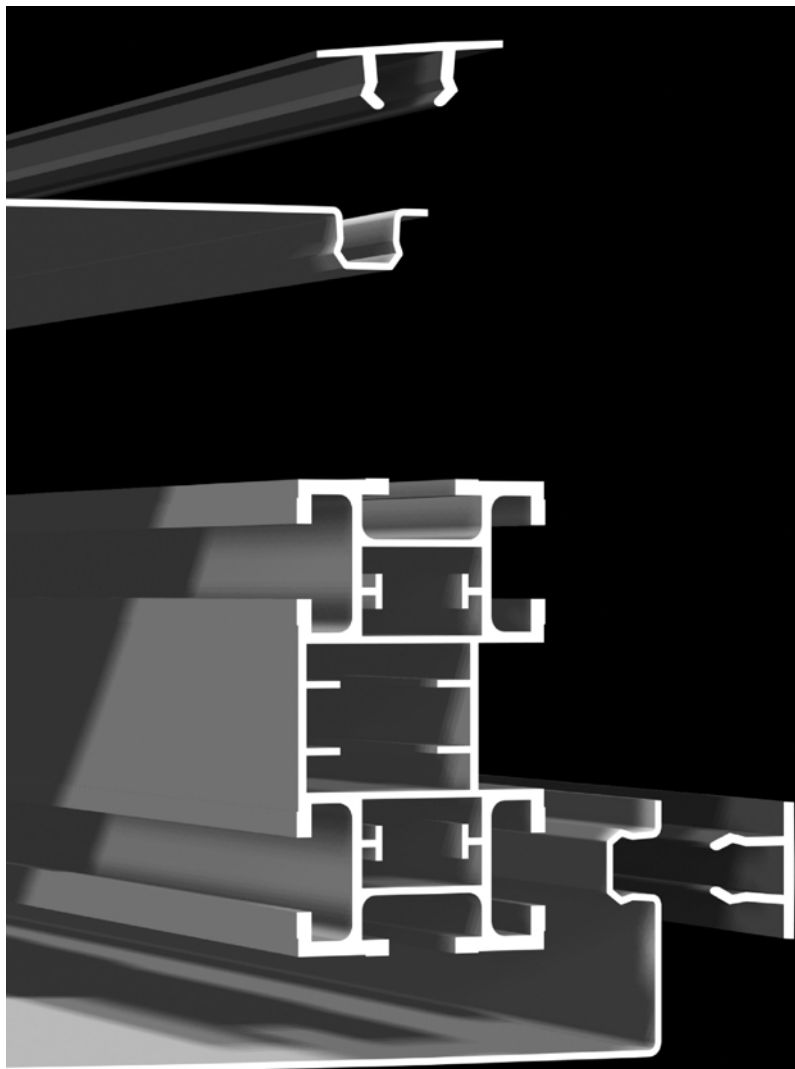

KT+

Frames with the
profile KT+

Simplicity

- No ready-made goods
- No eyelets
- No ropes
- No hems

Continual tension

- No clamps
- No clips
- No screw-system
- No strings

Simple assembly

- No special tools
- No heavy profile

Safety

- Tearproof up
to 1.360 Kg/m

EPS | ● |
Profiled Solutions

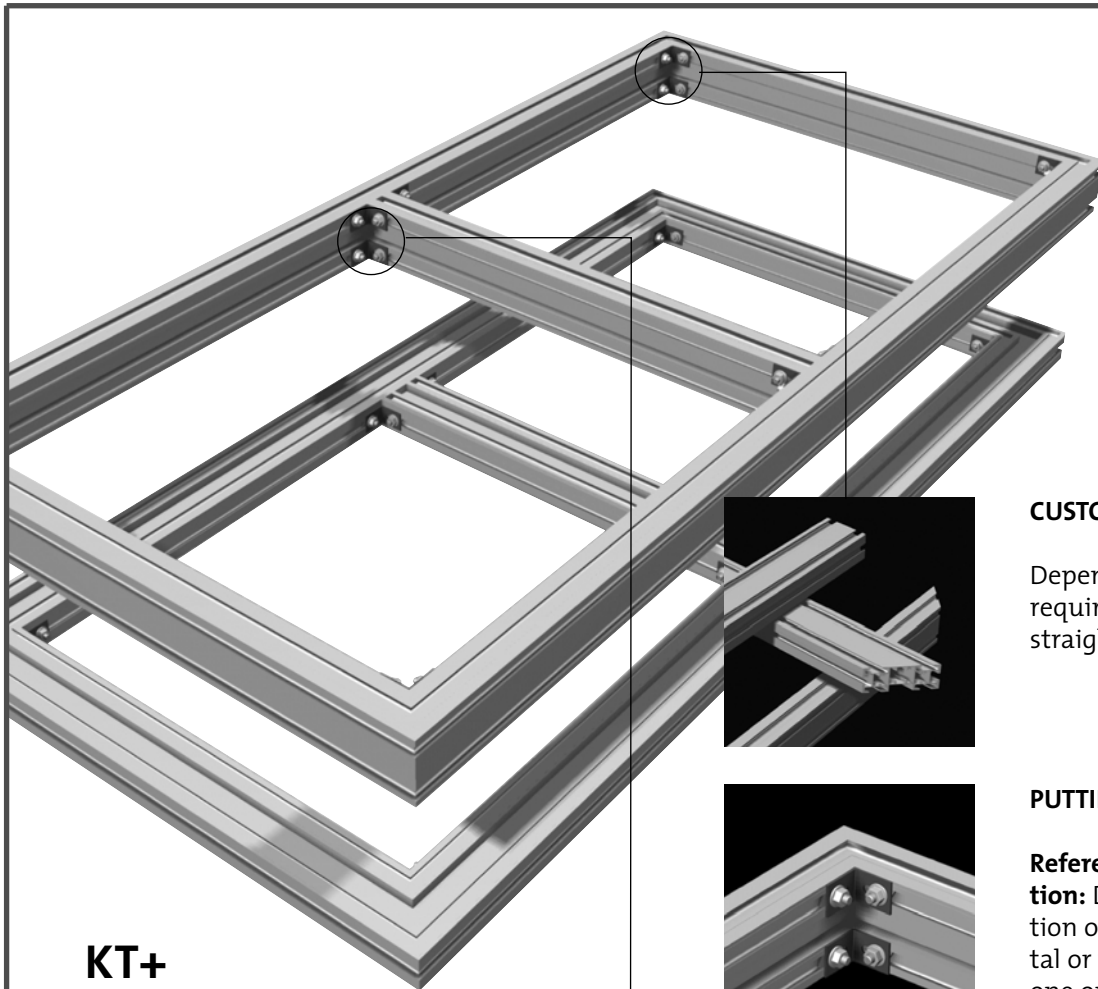

KT+

With the bearing profile KT+ bigger and medium frames can be produced. Covered on one side or on both sides : KT+ fulfills all your requirements with the reliable simplicity of the CRYSTAL-system. The idea behind it especially focuses on the realization of wall-frames outside.

reshapeable in one axis
minimum radius = 1000 mm

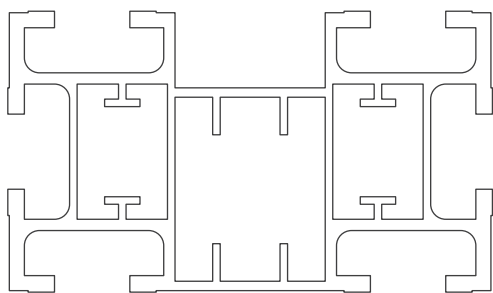

Size: 64 x 36,5 mm

CUSTOMIZING PROFILES

Depending on the construction required, saw off the profile straight or in an angle of 45°.

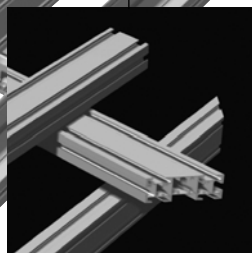

PUTTING THE FRAME TOGETHER

Reference to corner-construction: Depending on the position of the profile KT+ (horizontal or vertical), you should use one or two corner angles or corner reinforcements per corner.

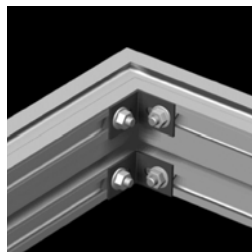

Insert corner angles EQABS into both central cells of one of the two profiles. Then shove the two parts into each other.



Afterwards fix the corners with one or two corner reinforcements EQ KT+ with the T-Nut CLM (two per bracket).



PLACEMENT OF A FRAME-SUPPORT

Only in specific cases - for independent and big dimensioned frames – a frame-support may be necessary. If that is the case, one or two corner reinforcements EQ KT+ with T-Nuts CLM are fixed to every end.



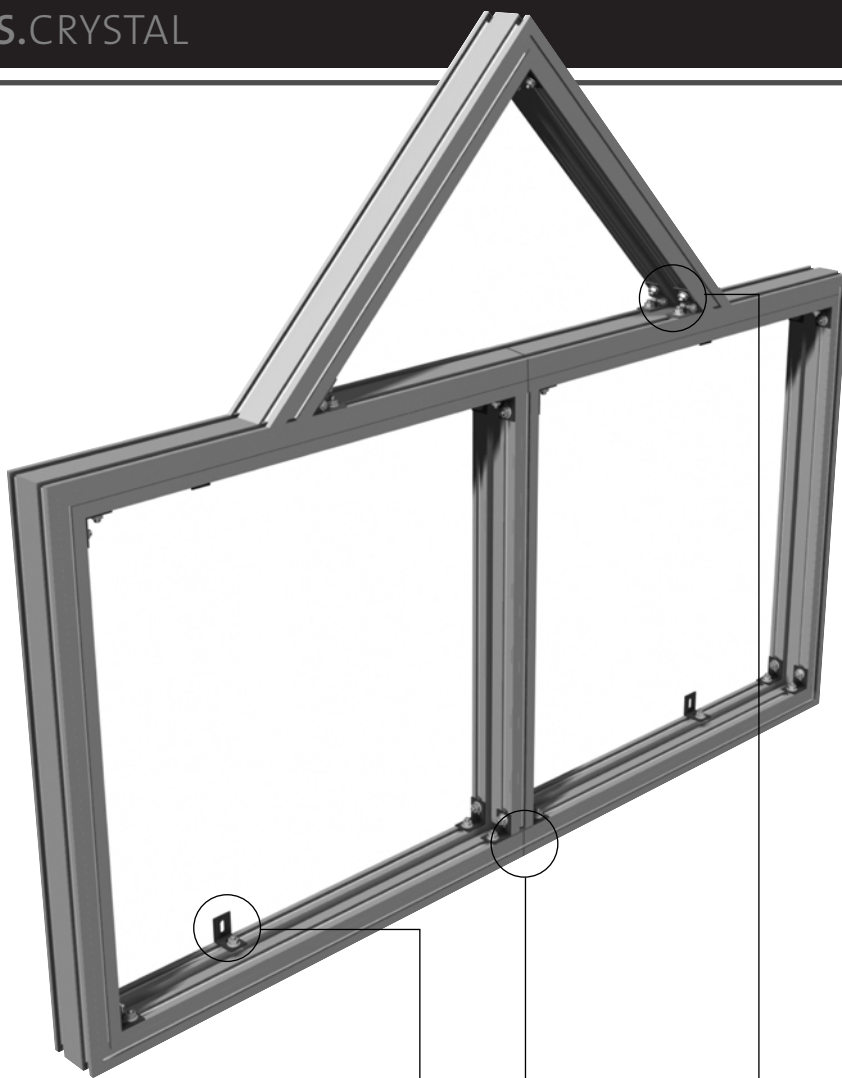

Example of a hexagonal construction

KT+

KT+ enables you to build different two- or three-dimensional frames and combine them with each other. The only limit is your fantasy.



Example of a formed construction with KT+

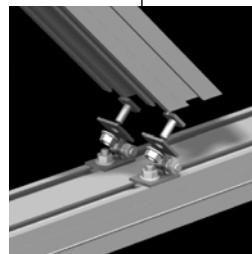

CONSTRUCTION OF THE CORNERS

With the adjustable corner reinforcement EQART KT+ you can construct corners from 0° up to 180°.

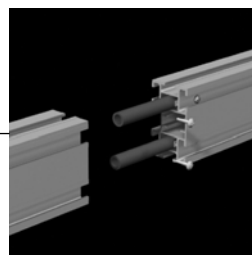

JOINT

Two TU joiner tubes, fixed with self-tapping screws, make great construction lengths possible.

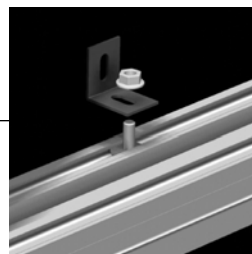

FASTENING

With the multifunctional bracket EQ KT+, installation on the wall is possible.

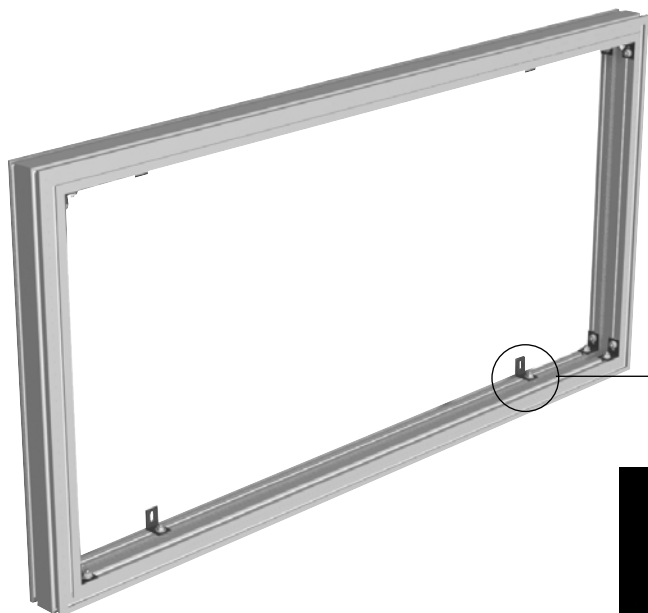

The conception of KT+ is especially suitable for solutions with wall-frames. You have two options:

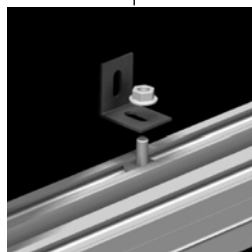

Fastening on the wall with the brackets EQ KT+ and the T-Nuts CLM.

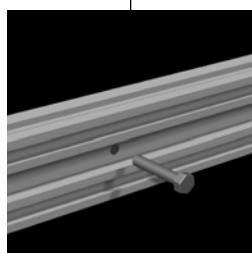
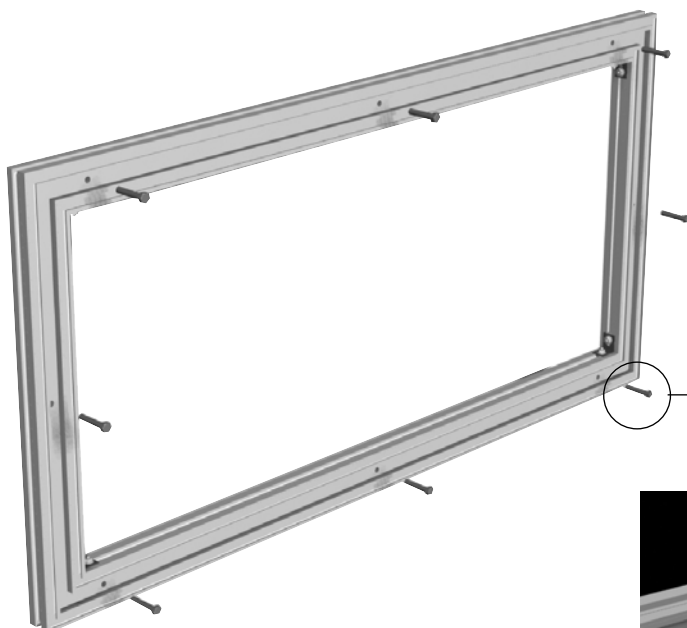

Screw joint directly through the profile KT+.



! The sort of screws and dowels depends on the kind of sub-soil. The person setting it up takes full responsibility.

10.2004



Example of a partition including fabric with insulating foam core.

The system KT+ offers you various possibilities fastening the clamping bar. It allows you to realise unique objects, e.g. the construction of a partition of a wall.

CLAMPING BAR IN FRONT

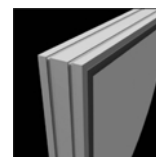
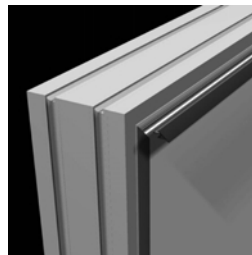

This is the classic fastening. For this the clamping bars need to be cut at an angle of 45°. This method permits a "framed" optical effect.

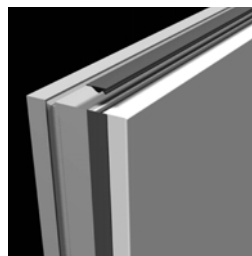

SURROUNDING CLAMPING BAR

This kind of fastening the clamping bar onto the surrounding exterior frame, permits an even more interesting presentation. The bar is only hardly visible from the front view.

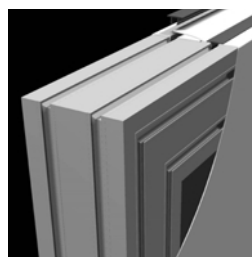

DOUBLE-SIDED

In case of a double-sided frame with surrounding clamping bars, it is possible to cover the aluminium-profile completely with the fabric with the double profile-nuts of KT+

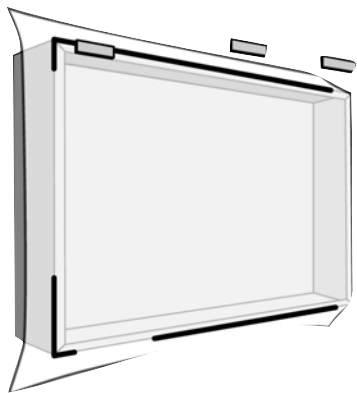

CUSTOMIZING OF THE FABRIC

The fabric needs to be approximately 10 cm wider than the frame on each side.

The fastening and tensioning of the fabric form the conclusion of the system. Please exactly follow the installation instructions and only use the tools recommended.

! Attention: To stretch the fabric, always use a non-rebound plastic hammer.

ALIGNING THE FABRIC

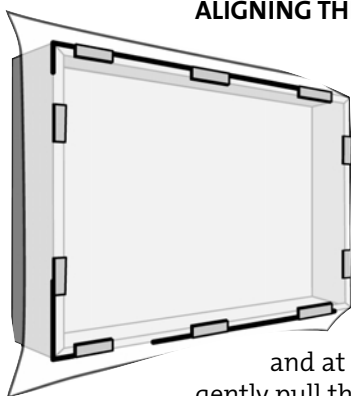

Place the short clamping profile pieces on the upper side for positioning and pretensioning.

Repeat this step at the lower side and at the sides. Now gently pull the fabric.

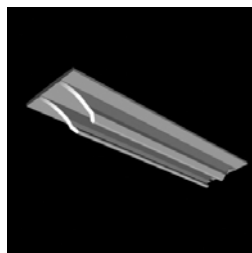

CLAMPING PROFILE SECTIONS

The profile-sections are remnant-pieces with a length of approximately 6 to 10 cm.

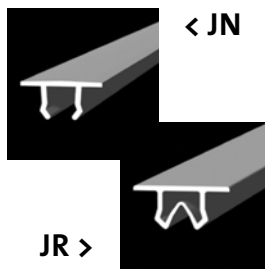

CHOICE OF CLAMPING BAR

For cases used inside, please choose the medium clamping bar JN. For the outside choose the strong clamping bar JR. The standard colour is white (different colours available).

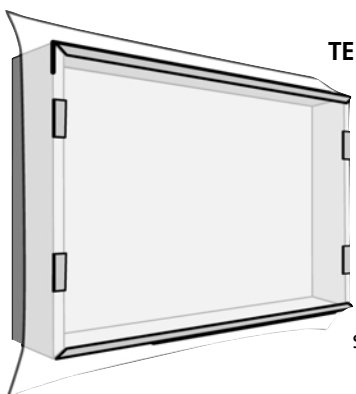

TENSIONING THE FABRIC

You fasten and tense the fabric with the clamping bar. Kindly note the position of the profile-sections.

Remove one profile-section after the other.



FASTENING OF THE CLAMPING BAR

Clamp the fabric by first of all shoving the bar from the exterior edge to the inside.

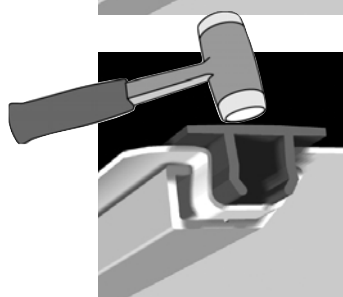

Hit the clamping bar with the plastic hammer into the profile nut. Doing this you stretch the fabric.

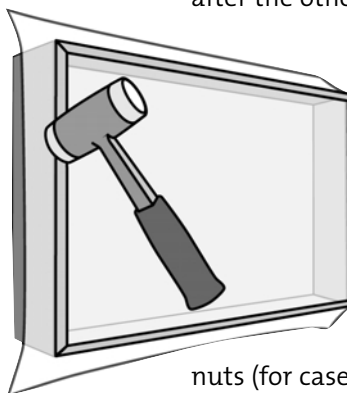

CUTTING OFF THE FABRIC

Once the fabric is tensed, the fabric is cut off along the clamping bar or in one of the profile-nuts (for cases with fabric on both sides).

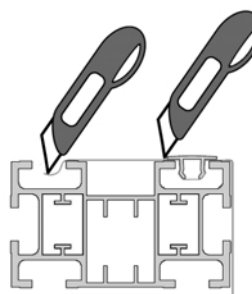

COMPONENTS AND PROFILES

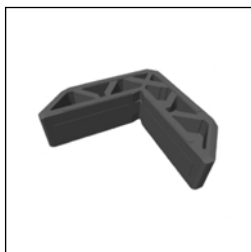

EQABS
Corner angle

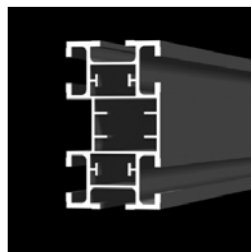

KT+
Profile

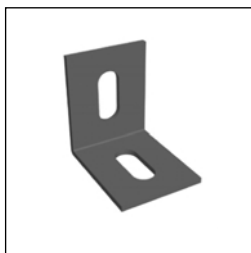

EQ KT+
Corner reinforcement

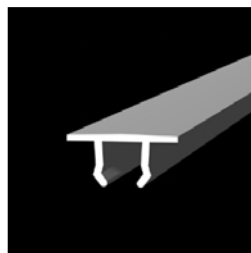

JN
Clamping bar medium

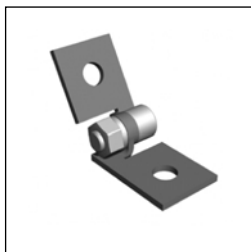

EQART KT+
Adjustable corner reinforcement



JR
Clamping bar strong



TU
Joiner tube

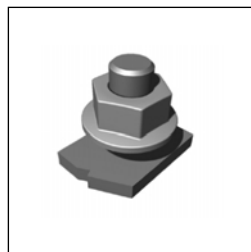

CLM
T-Nut



VisAFTR 3,5x13
Screw

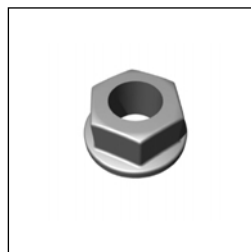

ECROU M6
Hexnut

 OUR TECHNICAL HOTLINE WOULD BE PLEASED
TO HELP YOU WITH ANY QUESTIONS:
+49 (0) 271/4 05 8143